

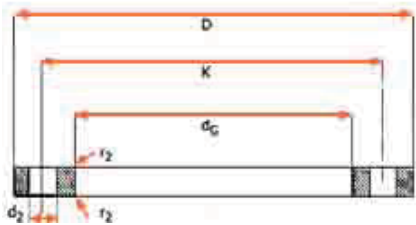

**Nominal pressure 16**



Nominal width	Nominal pressure 16 Bolts					
	D	d6	k	Quantity	Thread	d2
Mating dimensions , See under nominal pressure 40						
15 20 25	185	122	145	4	M 16	18
Mating dimensions , See under nominal n.p.40						
65 80 100	220	158	180	8	M16	18
125 150 (175)	250 285 315	188 212 242	210 240 270	8 8 8	M16 M20 M20	18 22 22
200 250 300	340 405 460	268 320 378	295 355 410	12 12 12	M20 M24 M24	22 26 26
350 400 (450) 500	520 580 640 715	438 490 550 610	470 525 585 650	16 16 20 20	M24 M27 M27 M30	26 30 30 33
600 700 800	840 910 1025	725 795 900	770 840 950	20 24 24	M33 M33 M36	36 36 39
900 1000 1200	1125 1255 1485	1000 1115 1330	1050 1170 1390	28 28 32	M36 M39 M45	39 42 48
1400 1600 1800	1685 1930 2130	1530 1750 1950	1590 1820 2020	36 40 44	M45 M52 M52	48 56 56
2000 2200 2400	2345 2355	2150 2360	2230 2440	48 52	M56 M56	62 62
No flanges standardized						
DN = Nominal size of metal ring				D = Outside diameter of metal ring		
D1 = Outside diameter of PE pipe				d6 = Inside diameter of metal ring		

**Office Address:**

No.8 (Suit 6), Nour Alley, Africa St., Tehran/IRAN.....

Tel.: (+98 21) 88 67 79 65 , 88 67 79 66, 88 67 39 19 , 88 67 39 18 - Fax: (+98 21) 88 87 85 81

[www.parsethylene-kish.com](http://www.parsethylene-kish.com)